

BORING #1

BORING #2

BORING #3

BORING #1	BORING #2	BORING #3
0:0" +11:2"	0:0" +11:5"	0:0" +12:4"
1:0" 1:0" Black sandy earth	2:6" 2:6" Black earth sandy	1:2" 1:2" Sand+fill.
3:4" 2:4" Ashes+sand fill.	3:10" 1:4" Yellow sand + loam	4:4" Fine yellow sand-some loam.
8:8" Fine yellow sand. Some loam to 7-10"	4:2" Fine yellow sand. some loam	5:6" W.S.
12:0" W.S.	8:0" W.S.	7:0" Fine yellow sand
12:0" -0:10"	11:2" 3:2" Fine yellow sand	12:6" W.S.
7:11" Fine grey sand	3:0" Fine grey sand.	15:11" Fine yellow sand. Very compact.
19:11" W.S.	20:2" -8:9"	20:6" Fine grey sand
20:6" 7" Coarse gravel	21:7" 1:5" Grey sand + gravel.	20:6" -8:2"
21:6" 1:0" Coarse sand-gravel	24:0" 2:5" Very tough yellow+blue clay.	2:9" Coarse sand + gravel
24:6" 3:0" Very tough blue clay.	29:11" 5:11" Tough blue clay.	23:3" 2:4:0" Hard gravel
30:3" -13:4"	37:0" 7:1" Stiff blue clay.	27:2" 3:2" Very tough blue+yellow clay
5:9" Tough blue clay.	44:6" 7:6" Tough blue clay.	30:0" 2:10" Tough blue clay.
10:3" Stiff blue clay. Some hard sand seams	48:9" 4:3" Stiff blue clay.	33:0" 3:0" Stiff blue clay.
40:6" -29:4"	52:4" 3:7" Tough blue clay.	16:6" Tough blue clay.
12:3" Tough blue clay.	55:2" 2:10" Stiff blue clay.	49:6" -37:2"
52:9" -41:7"	57:6" 2:4" Hard loam + clay.	5:7" Stiff blue clay.
5:9" Hard blue clay.	60:4" 2:10" Hard blue clay.	55:1" -42:9"
58:6" -47:4"		56:2" 1:1" Hard sand
		59:8" 3:6" Hard blue clay.
		-47:4"
		C.S.

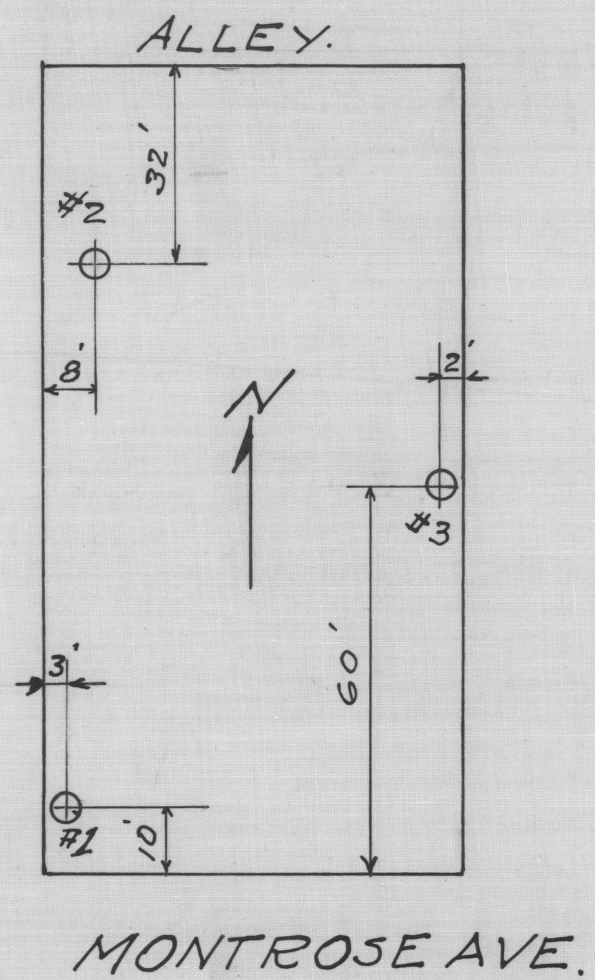

Notes:-
 -W.S. indicates wash sample taken at this point.
 -C.S. indicates core sample taken at this point.
 Elevation of Ground Water +2:0"
 The sand and sand and gravel from Elev. +3:0" approx. to the clay is all clean hard sand and very compact in all three borings.
 About 6' of good tough clay was encountered in all three borings immediately below the sand.
 No soft or "swelling" clay was encountered in these borings
 Numerous sand pockets were encountered in the clay below Elev. -22.

MAP ROOM
 4103
 a-4
 sh 498
 ILLINOIS GEOLOGICAL SURVEY LIBRARY

TEST BORINGS
 848-50 MONTROSE AVE.
 CHICAGO ILL.

SMITH AND KNAPP
 CIVIL ENGINEERS.
 7 S. DEARBORN ST
 CHICAGO ILL.

April 1927.